

CL-01 M DOUBLE SAFETY DOUBLE PINNED LIFT LANDING DOOR LOCKING DEVICE MOUNTING, ADJUSTMENT AND MAINTENANCE GUIDE

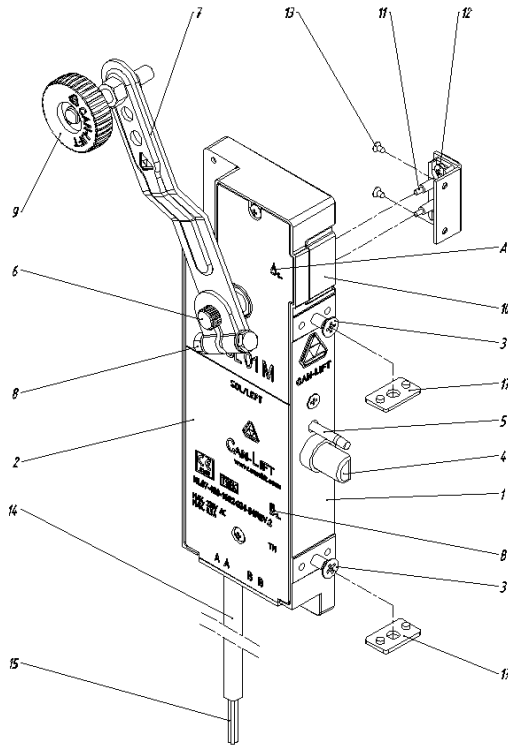

MOUNTING-ADJUSTMENT INSTRUCTION

- 1- Remove M6 bolts No 3 on the surface of the locking device body No 1.
- 2- Check that there are stiffening plates on the door frame that must be welded into the frame for lock mounting.
- 3- Mount the lock body on the door frame by using M6 bolts No 3.
- 4- Check the lock bolt No. 4, which enables the locking process to take place and check if the 2nd Safety Pin No. 5 is operating comfortably in the holes where it comes out of the door frame by moving it back and forth. If there is a situation that prevents its operation, enlarge the holes with a drill of appropriate diameter.
- 5- Attach the unlocking lever No. 7 to the knurled part of the mechanism draw lever shaft No. 6, with the roller No. 9 is positioned outside the lock body.
- 6- Tighten the unlocking lever locking bolt No. 8 by adjusting the unlocking lever according to the operating position of the Lift Landing Door Retiring Cam (Iirpomp) and fasten the mechanism draw lever shaft No. 6 and the unlocking lever together.
- 7- Mount the plug contact group No. 11 to the door wing using the mounting bolts of the plug contact group No. 13, in a manner so that it is at the same level with the plug contact counterpart contact group No. 10.
- 8- Make fine axis adjustment by using the plug contact group adjustment bolts No 12.
- 9- The cable connections of the contacts for the electricity connection can be set with the help of terminals through two different colored cables No. 15 that come out of the cable protecting hose No. 14.

Set the cable connections of the counter contact group No. 10, which is marked with the letter **A** and controls the full closing of the door, with the black-colored cables No.15 with the help of a terminal.

Set the cable connections of the safety contact inside the lock, which controls the complete execution of the locking operation marked with the letter **B**, with white-colored cables No. the help of a terminal.

the
15 with

1

Connect
body with
bolt No 16
Do not use a
grounding

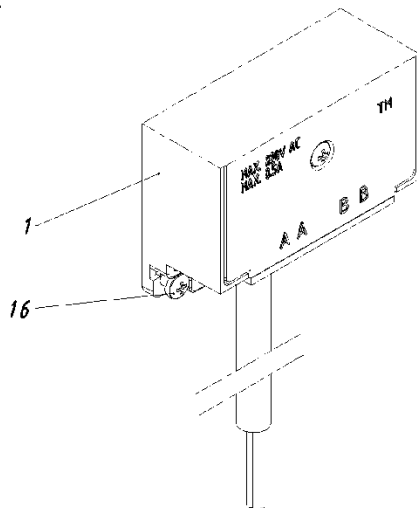

the grounding cable to the the help of the grounding shown in the picture No 2. socket terminal for a connection.

used in the CL-01 Double Device, the 2nd Safety Pin Only after it is achieved, the hole from which the undesirable reason, the forward, so the locking does not complete its diameter of the hole enlarge the hole with a

minimum gap of 2.5 mm less than this value, it

IMPORTANT NOTE

In order to deactivate the PRE-BLOCKING safety system Safety Double Pinned Lift Landing Door Locking No. 5 should protrude 2 mm from its hole in the frame. the locking system switches to the locking process. If 2nd Safety Pin No. 5 comes out is blocked for an lock blocks itself and the lock bolt No. 4 cannot move operation does not take place. In-lock safety contact cycle and prevents the system from operating. (If the prepared for the exit of the 2nd Safety Pin is small, Ø7 drill.)

A pre-blocking safety system has been developed with a between the door frame and door wing. If the gap is would not be possible to activate or deactivate the pre-safety system and the lock would block itself.

2 When the gap between the door frame and the door wing is less than 2.5 mm, pull the lock back inside the frame by using the black-color door gap adjustment plates No. 17 placed in the bags inside the lock box. In this way, you can activate the CL-01 M Double Safety Double Pinned Lift Landing Door Locking Device.

Door gap adjustment plates No. 17 are manufactured in different thicknesses. You can pull the lock back by using these plates between the lock front surface and the stiffening plate. The pin protrusions on the plates will be inserted into the holes on the mounting surface of the lock body. Since the thicknesses of the plates are different, use the plates with a sufficient thickness.

MAINTENANCE INSTRUCTION

- 1- Liquid oils should be used instead of solid oils during monthly routine maintenance of lifts, since solid oils accumulate dust and dirt on the working parts.
- 2- Check the healthy working conditions when carrying out the monthly routine maintenance as described during the mounting.
- 3- Do not execute any non-recommended interventions.
- 4- Do not disassemble inside of the lock even for repair and maintenance purposes.

- 5- During the general maintenance, if the lift door is required to be painted, lock must be dismantled and then mounted on its original place after the painting is completed. Paint residues that would enter into the working parts can lead to problems in operation of the lock, and paint removers can damage plastic parts.
- 6- If situations that prevent the conductance of working contacts are detected during monthly routine controls, apply proper cleaning to eliminate unfavorable conditions. If the contacts are required to be replaced, please contact our company.
- 7- **Operation life of the product is Ten (10) years. Warranty period is Two (2) years.**