

CL-05 M i DOUBLE SAFETY SINGLE PINNED LIFT LANDING DOOR LOCKING DEVICE MOUNTING-ADJUSTMENT AND MAINTENANCE GUIDE

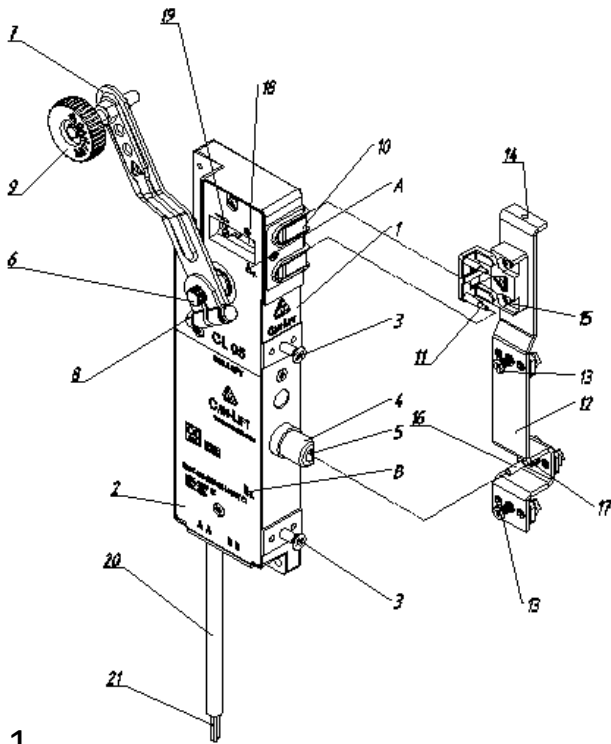

MOUNTING-ADJUSTMENT INSTRUCTION



- 1- Remove M6 bolts No 3 on the surface of the locking device body No 1.
- 2- Check that there are stiffening plates on the door frame that must be welded into the frame for lock mounting.
- 3- Mount the lock body on the door frame by using M6 bolts No 3
- 4- Attach the unlocking lever No. 7 to the knurled part of the mechanism draw lever shaft No. 6, with the roller No. 9 is positioned outside the lock body.
- 5- Tighten the unlocking lever locking bolt No. 8 by adjusting the unlocking lever according to the operating position of the Lift Landing Door Retiring Cam (lirpomp) and fasten the mechanism draw lever shaft No. 6 and the unlocking lever No. 7 together.
- 6- The cable connections of the contacts for the electricity connection can be set with the help of terminals through two different colored cables No. 21 that come out of the cable protecting hose No. 20.

Set the cable connections of the counter contact group No. 10, which is marked with the letter A and controls the full closing of the door, with the black-colored cables No.21 with the help of a terminal.

Set the cable connections of the safety contact inside the lock, which controls the complete execution of the locking operation marked with the letter B, with the white-color cables No. 21 with the help of a terminal.

Connect the grounding cable to the body with the help of the grounding bolt No. 22 shown in the picture No. 2. Do not use a socket terminal for a grounding connection.

- 7- The assembly of the plug contact No. 11 can be done with the help of the plug contact door mounting plate No. 12.
Remove the M5 bolts No. 13 from the plug contact door mounting plate No. 12. Hold from the upper curved part of the plug contact door mounting plate No.12 and insert it into the hole on the door wing. If you think that the curved part will slip out of your hand during this process, you can use hole No 14. A piece of string or wire that you will attach to the hole No 14 would help you. After the plug contact door mounting plate is aligned to its mounting place, mount to the door wing with the help of bolts No. 13. Do not tighten completely as adjustment will be made.
- 8- After the plug contact door assembly is done simply, the length and axis adjustment of the 2nd Internal Safety Pin Ejector Pin No.16 should be made according to the axis of the 2nd Internal safety pin No. 5. During the first mounting, set the height and axis adjustment using the hexagonal headed nut No. 17. After the adjustment, fix the position by tightening the bolt No. 13 and the tooth-locked cup washer.
In order to correct the aligning errors that will occur over time during maintenance, instead of using the hexagon-headed nut no. 17, loosen the bolt No. 13, adjust the axis and tighten it again.
- 9- As explained above, if you make the 2nd Internal Safety Pin Ejector Pin No. 16 adjustment with the help of bolt No. 13, the axis adjustment of the contact no.

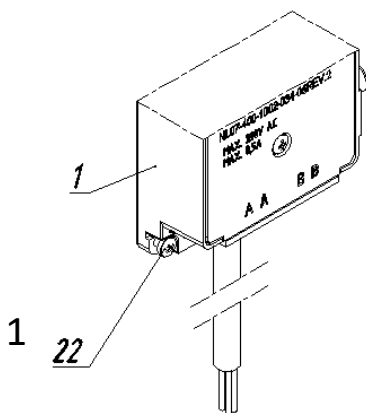

11 is disrupted.

It is possible to make the axis adjustment independently by loosening the plug contact mounting bolts No. 15.

Thanks to this superior feature we have added to our product, the axis adjustments of the push pin No. 16 and the contact No. 11, which are difficult to set, have been simplified so that they can be made independently of each other.

10- Loosen the locking bolt No. 18 in order to adjust the axis of the plug contact no. 10 back and forth. Then, manually adjust the back and forth adjustment using pin No. 19 on the plug contact counter contact No. 10. Finally, fasten the position by tightening the bolt No 18.

**** Bolt No. 18 must be loosened while adjusting back and forth and must be tightened again after adjustment.**

MAINTENANCE INSTRUCTION

- 1- Liquid oils should be used instead of solid oils during monthly routine maintenance of lifts, since solid oils accumulate dust and dirt on the working parts.
 - 2- Check the healthy working conditions when carrying out the monthly routine maintenance as described during the mounting.
 - 3- Do not execute any non-recommended interventions.
 - 4- Do not disassemble inside of the lock even for repair and maintenance purposes.
 - 5- During the general maintenance, if the lift door is required to be painted, lock must be dismantled and then mounted on its original place after the painting is completed. Paint residues that would enter into the working parts can lead to problems in operation of the lock, and paint removers can damage plastic parts.
 - 6- If situations that prevent the conductance of working contacts are detected during monthly routine controls, apply proper cleaning to eliminate unfavorable conditions. If the contacts are required to be replaced, please contact our company.
- Operation life of the product is Ten (10) years. Warranty period is Two (2) years.**